

KILBOURN EXTENSION to MACARTHUR SQUARE

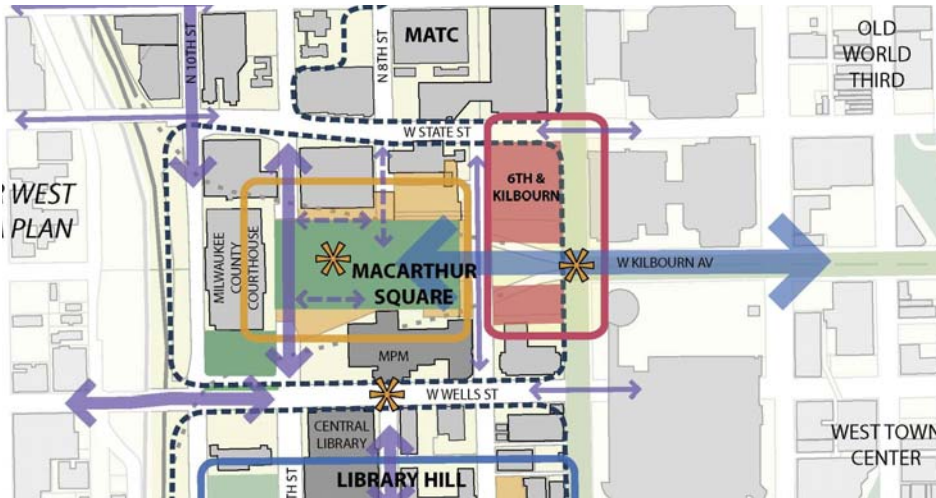

Kilbourn Boulevard Extension

A two-block development site on the easternmost portion of the MacArthur Square District.

A MacArthur Square redevelopment could be accomplishing in two distinct phases. In the First phase a number of key changes could take place:

- Development of the existing parcel at 6th and State with design consideration for a future freeway ramp/tunnel entrance relocation and Kilbourn Avenue extension to 7th Street could be the first aspect of Phase 1.
- This development block could include a substantial parking facility that could both serve the development as well as alleviate parking needs currently accommodated in the MacArthur Square garage. Provisions for under-street connections to the main MacArthur Square future garage should be considered.
- Relocation of the ramps to the freeway tunnels and extension of Kilbourn Avenue to 7th Street would then free up additional development space fronting on the newly established street. Lands would not only be available on the north with the possibility of a development connection to the 6th and State development, but would also include a similar site on the south adjacent to the State of Wisconsin office building.
- 6th Street and Kilbourn Avenue would be reconfigured to both address the new freeway ramp locations, as well as improve the pedestrian crossings of 6th Street.
- Kilbourn Avenue, from 6th to the Milwaukee River, could be reconfigured with an adjusted lane pattern, wider median areas, additional planting, and other elements to better connect MacArthur Square to the Pere Marquette Park and the river.

In the Second Phase:

- Strategic removal and replacement of the existing MacArthur Square garage could occur. Upon reconstruction, Kilbourn Avenue could continue to be extended to a wrap a new, reduced scale public square.
- The public street access to the area of the existing MacArthur Square allows creation of new development site on this newly established connecting road.
- Shared underground garages can serve current needs of existing perimeter tenants as well as accommodate new uses and developments established on the square.



KILBOURN EXTENSION to MACARTHUR SQUARE

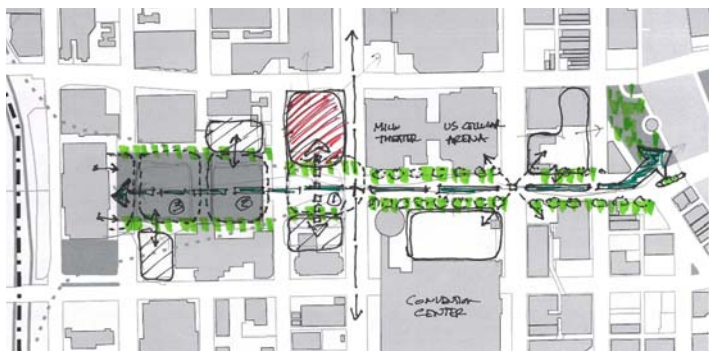
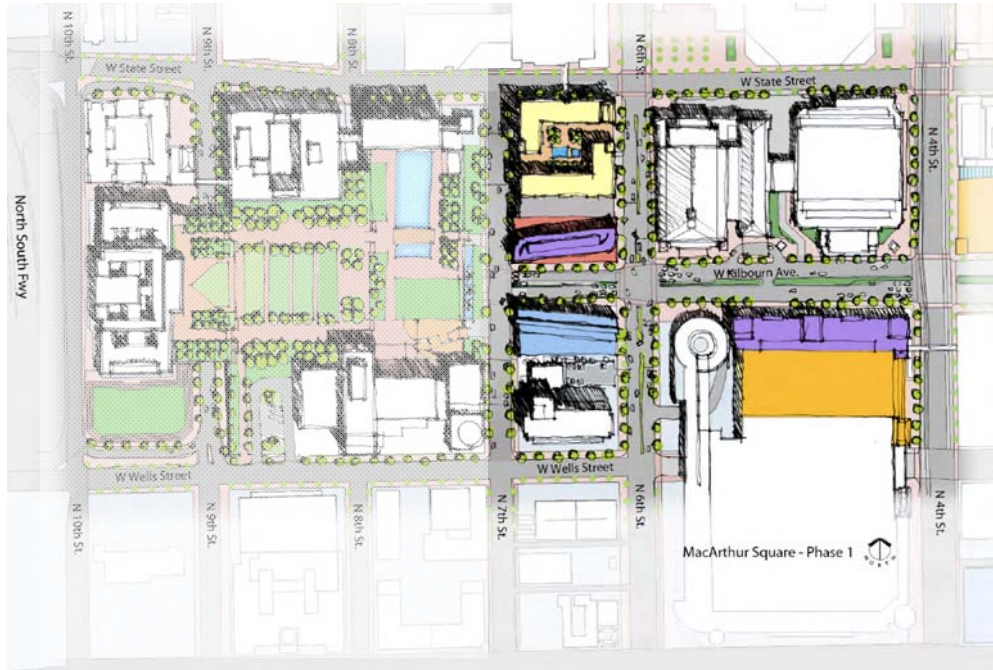

KILBOURN EXTENSION to MACARTHUR SQUARE

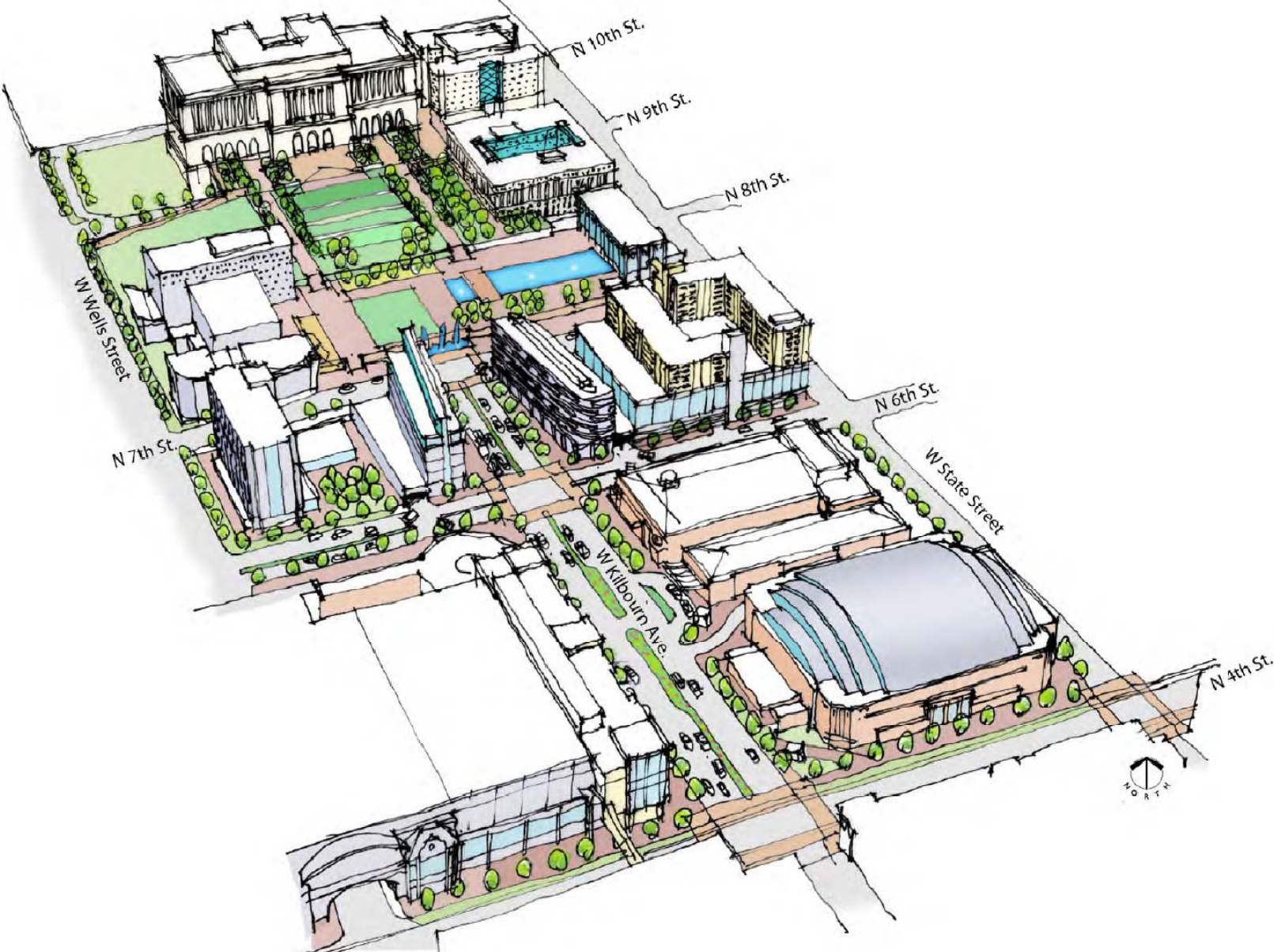

KILBOURN EXTENSION TO MACARTHUR SQUARE

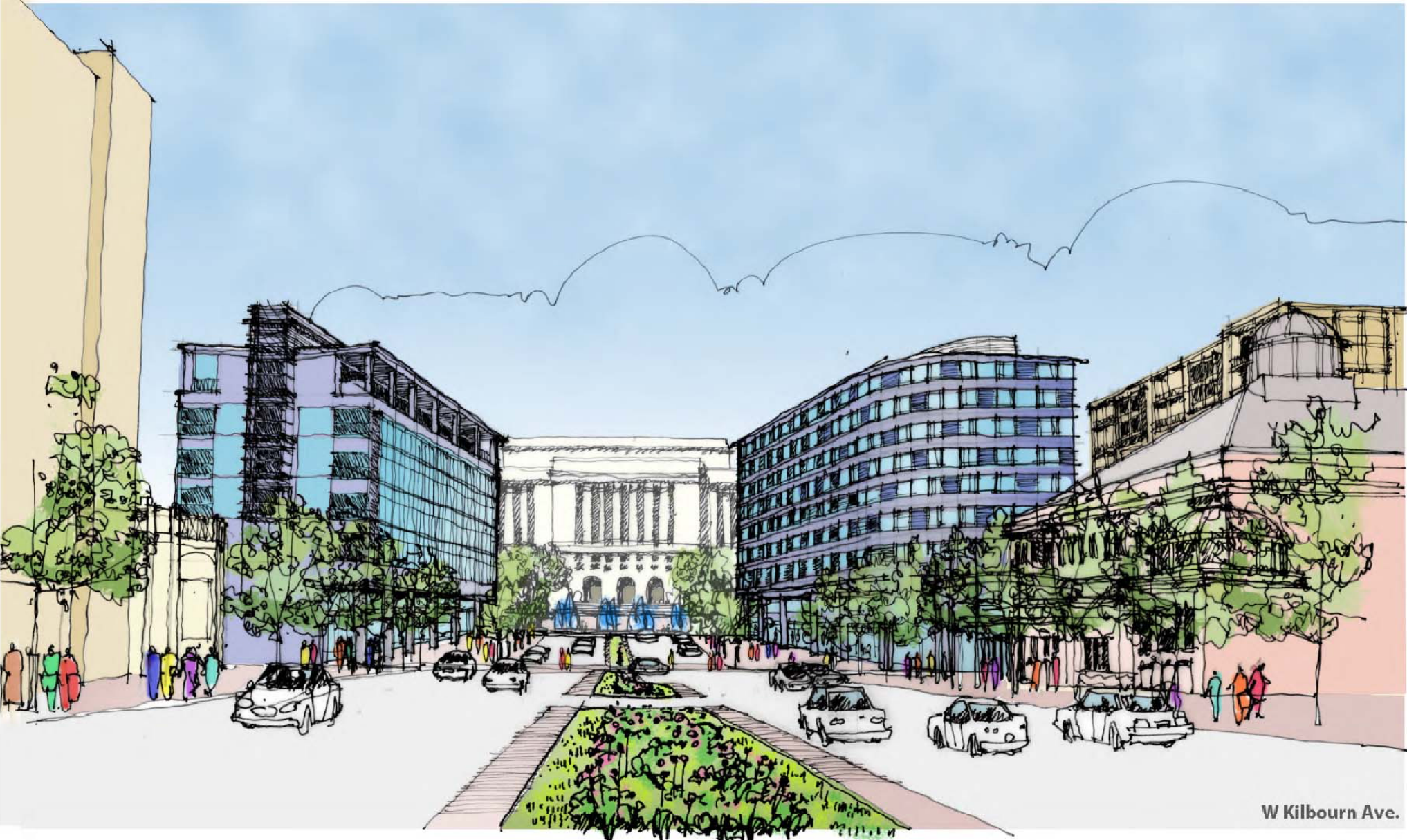

W Kilbourn Ave.